



**11/24 Picnic Point Esplanade Maroochydore QLD**

3  2  1 

Wake up every morning to enviable, uninterrupted views of the Maroochy River in this beautifully presented Picnic Point top floor apartment. Located in the exclusive 'Picture Point' complex, directly opposite the river and minutes stroll to beaches, shops, and the local restaurant precinct, this home offers the best of Sunshine Coast living.

One of two top floor apartments, this home comprises three bedrooms, two bathrooms, including the master ensuite, a laundry room, and a light-filled open plan living, dining and kitchen area that opens out onto the expansive balcony overlooking the river. A second balcony at the rear of the apartment offers views of the canal and Buderim mountain.

Enjoying a northerly aspect, the sunny, open plan living

**Type** : Unit  
**Price** : \$ 950,000  
**View** : <https://www.harvestinggroup.com.au/8290240>



**Shannon Turner**  
0479 164 261



**Marg Turner**  
0417 399 937

[For full version visit the website](https://www.harvestinggroup.com.au)

11/24 Picnic Point Esplanade, **MAROOCHYDORE**

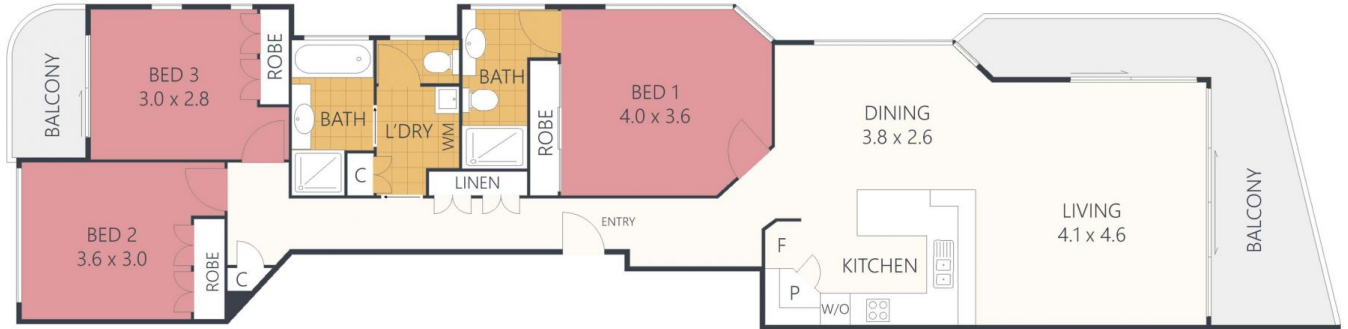

INTERNAL: 112m<sup>2</sup> EXTERNAL: 20m<sup>2</sup> TOTAL: 132m<sup>2</sup> CARPARK/STORAGE 18m<sup>2</sup>

**ARTIST'S IMPRESSION ONLY:** While every attempt has been made to ensure the accuracy of this floor plan's areas and measurements of doors, windows, rooms and all other items are approximate and no responsibility is taken for any error, omission, or mis-statement. This plan is for illustrative purposes only and should only be used as such by any prospective purchaser. Floor plan by: [www.realestatefloorplans.com.au](http://www.realestatefloorplans.com.au)

