



5/18-22 Picnic Point Esplanade Maroochydore QLD

3  2  1 

Located on the first floor of 'The Esplanade' complex, directly opposite the magnificent Maroochy River, showcasing a sparkling water vista from two separate balconies and virtually every room; this expansive, light-filled apartment, in absolutely pristine condition offers the ultimate waterfront lifestyle.

Comprising three bedrooms, two bathrooms, study nook, open plan living and dining, well-equipped central kitchen, expansive open plan living flowing to north-east facing balcony, additional balcony off master and second bedroom, separate laundry, and secure parking for one vehicle; this is the perfect size for a couple/single or small family, and the perfect location for anyone!

Type : Unit
Land Size : 131 sqm
View : <https://www.harvestinggroup.com.au/8290237>



Shannon Turner
0479 164 261



Marg Turner
0417 399 937

[For full version visit the website](https://www.harvestinggroup.com.au)

5/18 Picnic Point Esplanade, **MAROOCHYDORE**

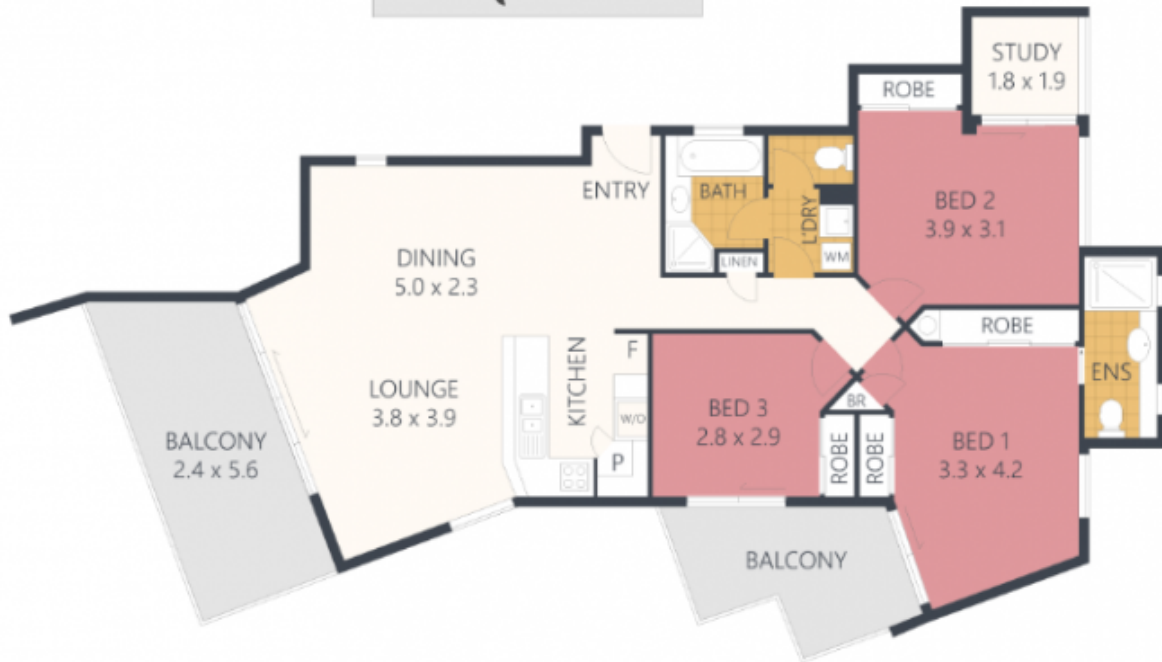

INTERNAL: 109m² EXTERNAL: 22m² TOTAL: 131m²

ARTIST'S IMPRESSION ONLY: While every attempt has been made to ensure the accuracy of this floor plan's areas and measurements of doors, windows, rooms and all other items are approximate and no responsibility is taken for any error, omission, or mis-statement. This plan is for illustrative purposes only and should only be used as such by any prospective purchaser. Floor plan by www.realestatefloorplans.com.au

